

# STAGE PLOT & TECHNICAL SPECIFICATIONS

## SOME ASSEMBLY REQUIRED

ELYSE BRUCE

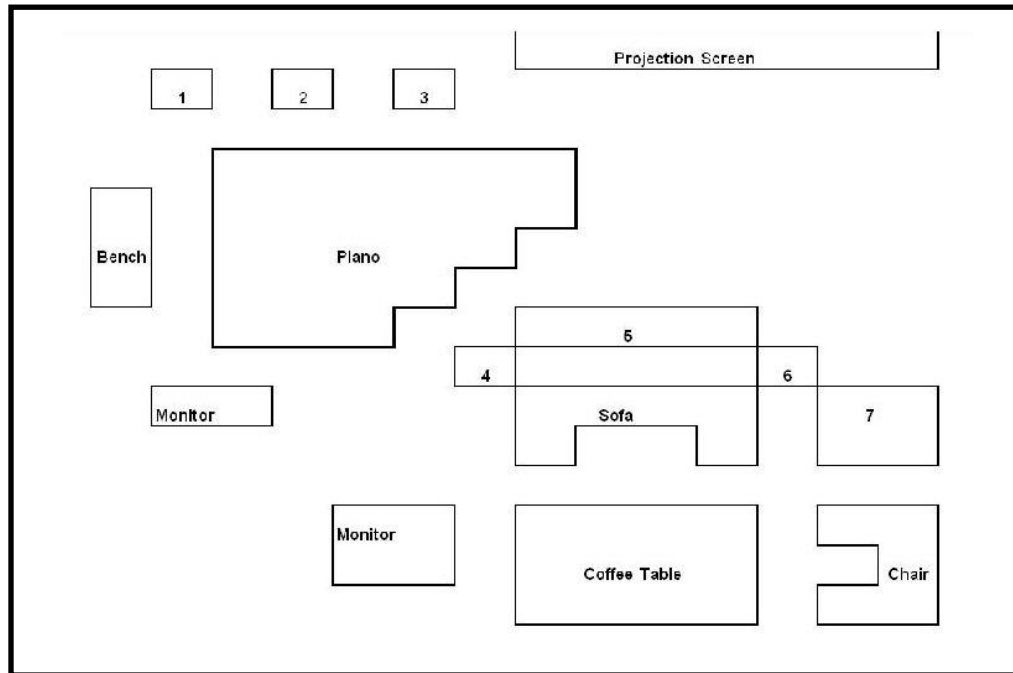

1. Tall potted plant
2. Tall potted plant
3. Tall potted plant
4. Tall potted plant or small plant on a table
5. Long table with small lamp, small statue, photo frame and plants
6. Tall potted plant or small plant on table
7. Square coffee table with small lamp and/or small plant, coffee mug and magazines.

Baby grand piano (acoustic) and piano bench  
Sofa or love seat with cushions  
Padded chair, preferably matching the sofa or love seat  
Long coffee table with magazines

Optional: Various items that add to the impression of a Living Room including such items as afghans; wool, yarn and needles in a basket on one of the tables; decorative bowls; and basket a dog would lie down in.

Purpose: The stage must closely approximate a comfortable, intimate and inviting Living Room. Attention to detail is imperative to provide a 'lived in' look that simulates a welcoming home environment.

## **AUDIO EQUIPMENT**

Supplied by the purchaser

## **SOUND BOARD OPERATOR**

Supplied by the purchaser

## **LIGHTING EQUIPMENT**

Supplied by the purchaser

## **LIGHT BOARD OPERATOR**

Supplied by the purchaser

## **MULTIMEDIA EQUIPMENT**

Supplied by the purchaser

## **MULTIMEDIA BOARD OPERATOR**

Supplied by the purchaser

## **MINIMUM STAGE REQUIREMENTS**

16' depth x 16' width x 10' height

## **PERSONNEL**

Manpower to set up and strike the set  
Audio, Lighting and Multimedia operators

## **OTHER REQUIREMENTS**

Baby Grand Piano (tuned) and piano bench  
Stage props described on the Stage Plot page (page 1)  
Projection Screen for photographs on Power Point  
Power Point Program on Computer  
Extension cords as needed  
Electrical circuits as needed  
Monitors (at least 2: one by the piano and one by the sofa)

## **SET UP TIME**

2 hours (approximate)

## **STRIKE**

1 hour (approximate)

## **PERFORMANCE**

90 minutes